

Preisliste 2015



Product Picture



Feature of product (HQ52 SERIES) :

1, LED :	Energy saving	*Super bright led , SMD2835
		*high CRI (color rendering index) 83 Ra . Much healthier for human eyes
	Healthy light	*Choosing a narrow range of Bin to keep perfect color consistence (by ANSIC78.377A standard)
2,Driver :	Good performance	* PF: 0.95, efficiency : 89% and THD<15%
	Long lifespan	*The capacitor which decide the life of driver is using Rubycon YXF family , best capacitor from Japan
	Safty	*Constant current isolated circuit design ; output voltage is lower than 42.4V, which is safe for man-touch; with over-current , overvoltage and short-circuit protection
3,Endcap		*Rotate endcaps which can adjust any angle of tube you need
4,warranty		* 4 years warranty
5,Certificate		VDE, TUV EMC ,TUV Rohs, PSE

T8 LED tube— 600mm

Model number	Specification							Price		
	Dimension	Rated Power	Power Factor	THD	CCT(K)	CRI(Ra)	Luminous flux (from IES report)	< 100	< 500pcs	>1000pcs
	600mm* ϕ 26mm	10W	0,95	15%	3000/4000/5000/5700	83	Frosted lens: 1000lm clear lens: 1100lm	15,00 €	14,20 €	13,50 €

T8 LED tube— 900mm

Model number	Specification							Price		
	Dimension	Rated Power	Power Factor	THD	CCT(K)	CRI(Ra)	Luminous flux (from IES report)	< 100	< 500pcs	>1000pcs
	900mm* ϕ 26mm	14W	0,95	15%	3000/4000/5000/5700	83	frosted lens: 1400lm	19,50 €	18,50 €	17,50 €

T8 LED tube— 1200mm

Model number	Specification							Price		
	Dimension	Rated Power	Power Factor	THD	CCT(K)	CRI(Ra)	Luminous flux (from IES report)	< 100	< 500pcs	>1000pcs
	1200mm* ϕ 26mm	18W	0,95	15%	3000/4000/5000/5700	83	Frosted lens: 1800lm clear lens: 1950lm	23,50 €	22,00 €	21,00 €
	1200mm* ϕ 26mm	21W	0,95	15%	3000/4000/5000/5700	83	Frosted lens: 2050lm clear lens: 2250lm	24,30 €	22,80 €	21,80 €

T8 LED tube— 1500mm

Model number	Specification							Price		
	Dimension	Rated Power	Power Factor	THD	CCT(K)	CRI(Ra)	Luminous flux (from IES report)	< 100	< 500pcs	>1000pcs
	1500mm* ϕ 26mm	25W	0,95	15%	3000/4000/5000/5700	83	Frosted lens: 2650lm clear lens: 2850lm	29,80 €	27,50 €	26,50 €
	1500mm* ϕ 26mm	30W	0,95	15%	3000/4000/5000/5700	83	Frosted lens: 3150lm clear lens: 3350lm	33,00 €	31,00 €	30,00 €

Product packing :

Length	qty /carton	carton size (mm) L*W*H	weight	qty /40'GP container	qty /40'HP container
600 mm tube	20pcs /ctn	670*240*200	7.5kg	36200pcs	40500pcs
900mm tube	20pcs /ctn	970*240*200	10.5kg	24850pcs	27850pcs
1200mm tube	20pcs /ctn	1270*240*200	12.5kg	19000pcs	21300pcs
1500mm tube	20pcs /ctn	1570*240*200	16.5kg	15350pcs	17200pcs



Note :

- 1, payment terms : 50% TT as deposit , 50% TT balance before shipment
- 2, Price Terms : FOB shenzhen
- 3, MoQ : 1000pcs for each model and color
4. Lead time : 7days for sample order, 25days for bulk order
5. Aluminum PCB will add 1 usd on cost

Installation :

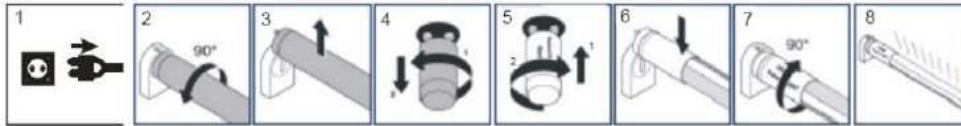

- 1, Switch off electricity (if luminaire)
- 2, Remove the conventional lamp
- 3, Remove the starter
- 4, Install the retrofit starter version into the starter holder
- 5, Install the retrofit led lamp into the lamp holder
- 6, Secure the position by turning the lamp by 90 °

Magnetic ballast :

