

The background of the slide features a dark, semi-transparent image of LED track lighting components. On the left, there is a close-up of a light head with a visible lens and internal components. On the right, there is a track system with a light head mounted on it, showing the track's profile and mounting structure.

LED**OX** Track Light

Focus Makes Profession

2015.08

A deep space photograph showing a vast field of stars against a dark cosmic background. A prominent, glowing blue nebula or interstellar dust cloud is visible, particularly on the right side of the frame. The stars vary in brightness, with a few showing distinct diffraction spikes. The overall color palette is dominated by deep blues and blacks, with the white light of the stars providing contrast.

We have a dream...



INNOVATION

We Will Rock
The World



By lighting up the world with LEDOX light



Let everyone enjoy a Safe, Energy-save
and Green world, make your world shinny
because of our lamp

We are devoted to...

Making the best track light
people have never seen before...



POSITIONING:

Power:	15W 25W 35W
Design:	Unique & Patented Design
Standard:	Wide application, good compatibility
Market:	Top-end
Warranty:	5 years

15W

Power: 15±5%W

Input Voltage: AC220-240V

Current: 350mA

PF: 0.9

Photo Parameters

CCT	2700K	3000K	4000K
Lumen	1100±10%	1200±10%	1300±10%
CRI	>90	>90	>90
Efficacy	73lm/w	80lm/w	87lm/w

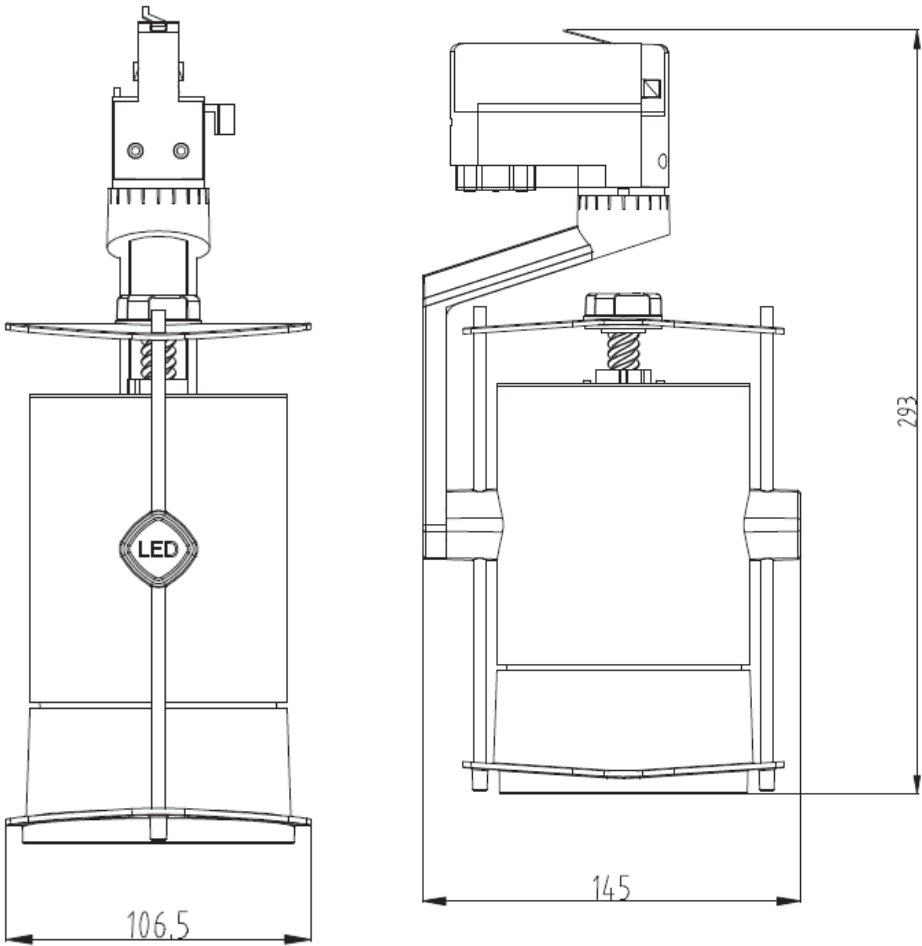

25W

Power: 25±5%W

Input Voltage: AC220-240V

Current: 600mA

PF: 0.9

Photo Parameters

CCT	2700K	3000K	4000K
Lumen	2000±10%	2100±10%	2200±10%
CRI	>90	>90	>90
Efficacy	80lm/w	84lm/w	88lm/w

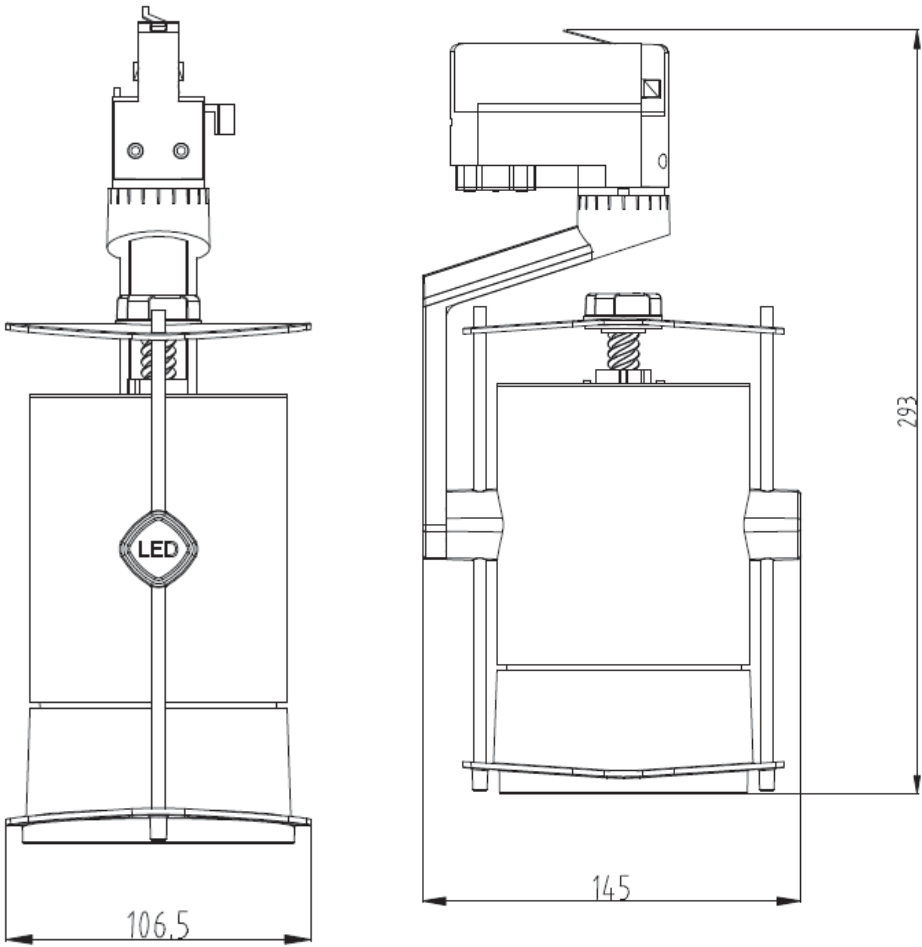

PART I PRODUCT PARAMATERS

35W

Power: 35±5%W

Input Voltage: AC220-240V

Current: 850mA

PF: 0.9

Photo Parameters

CCT	2700K	3000K	4000K
Lumen	2800±10%	2900±10%	3000±10%
CRI	>90	>90	>90
Efficacy	80lm/w	83lm/w	86lm/w

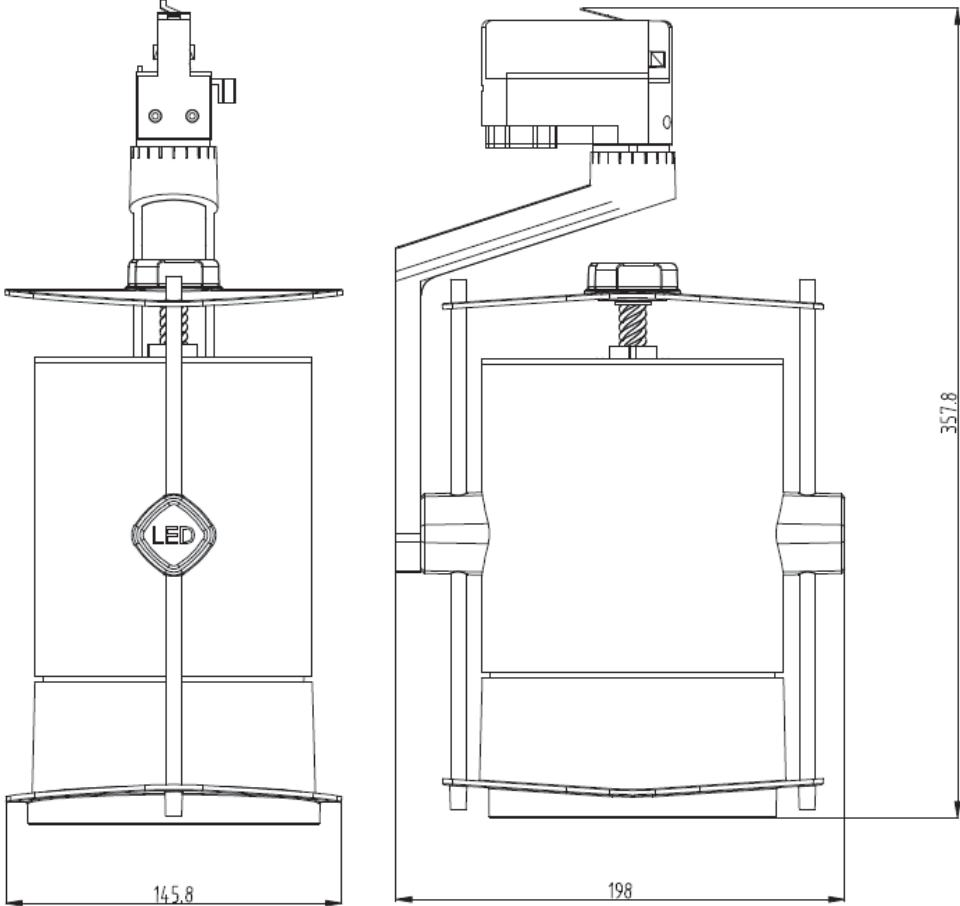

ADVANTAGES

Focus Makes Profession

ART DESIGN

- ❑ Oval shape
- ❑ Elegant streamlines
- ❑ Metallic



Two Driver Options

- ❑ Internal driver
- ❑ External driver

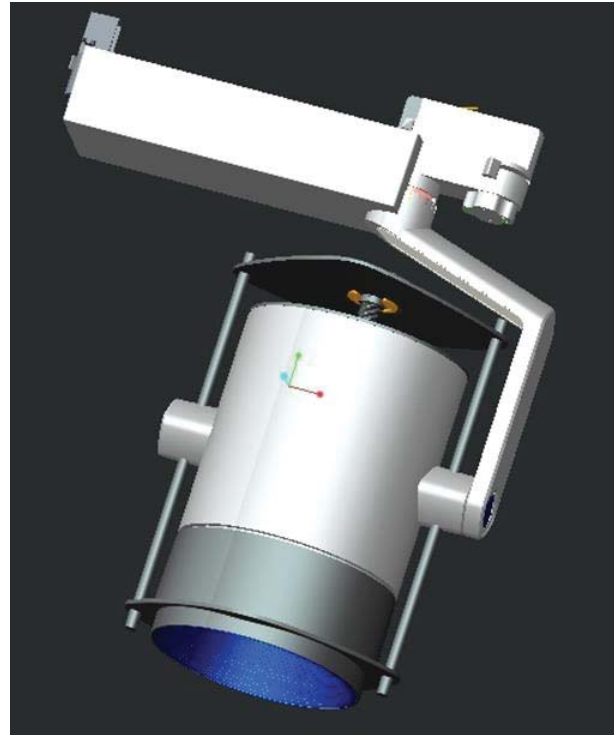

Excellent Compatibility

Match with Standard Tracks



SALT Fog Resistance & Anti-Humid test approval

Up to 8 degree > 0.1- 0.25



CREE COB

- ❑ CRI>95
- ❑ Up to 80lm/W
- ❑ Brand reputation
- ❑ Stable performance
- ❑ Partner of Cree, Inc.
 - Better support



Beam Angle

Adjustable from
24° to **60°** freely
smooth

24°, 25°, 26° ... 60°



Top End Fresnel Lens



Normal optic design in market



Special Fresnel optic solution

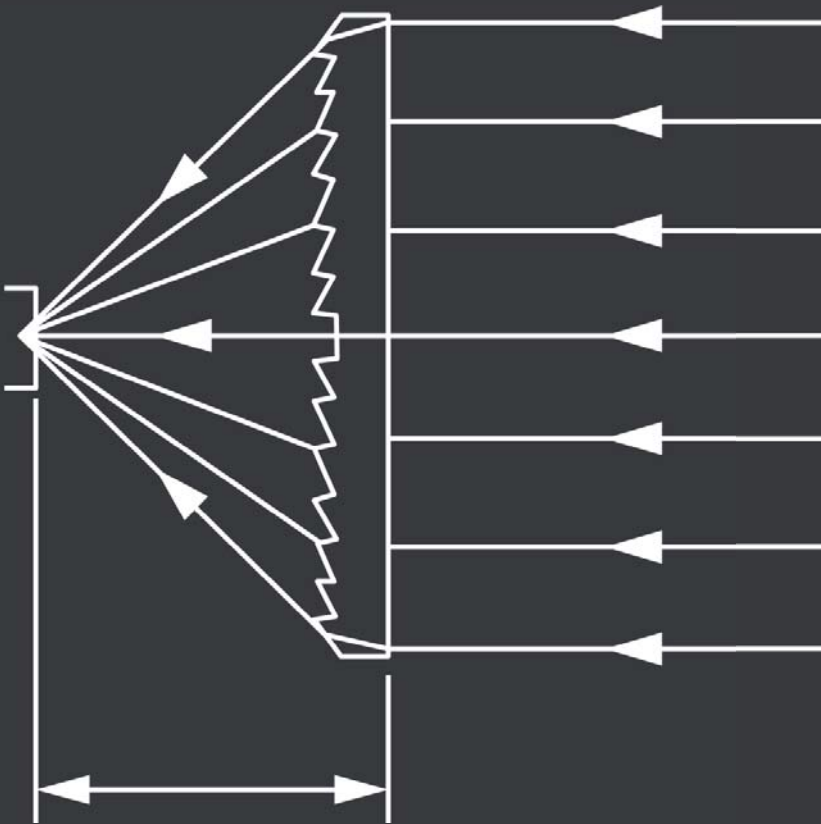

When adjust angle, light decrease <5%

(normal decrease is 20-50%)

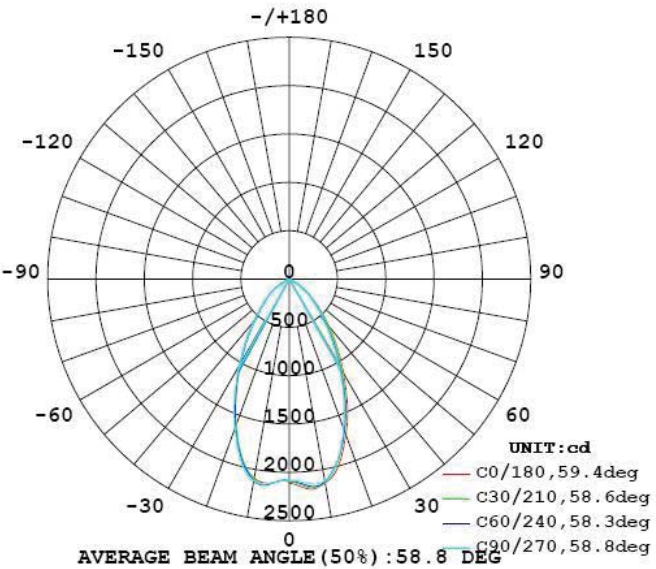
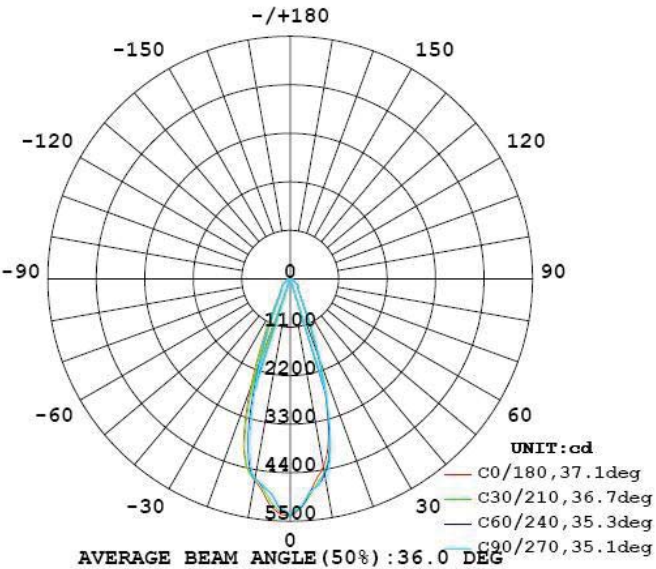
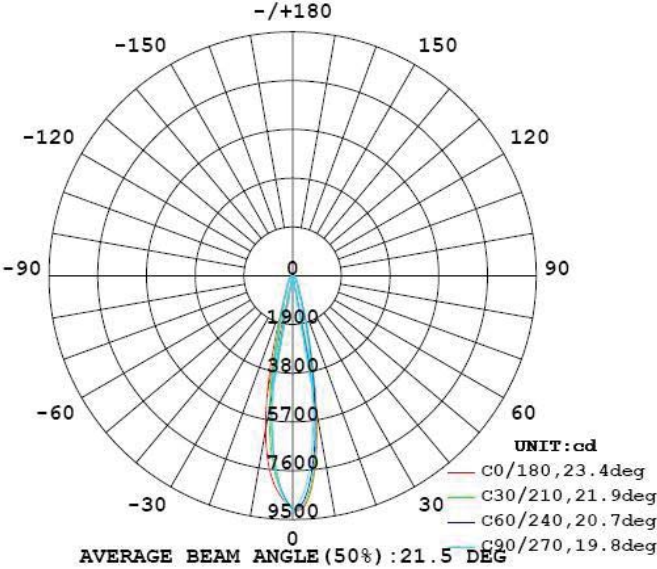

Precise angle control

Two parallel metal rods control the focal length, keep adjusting precise and smooth



Perfect light distribution

Very focus light, uniform space distribution

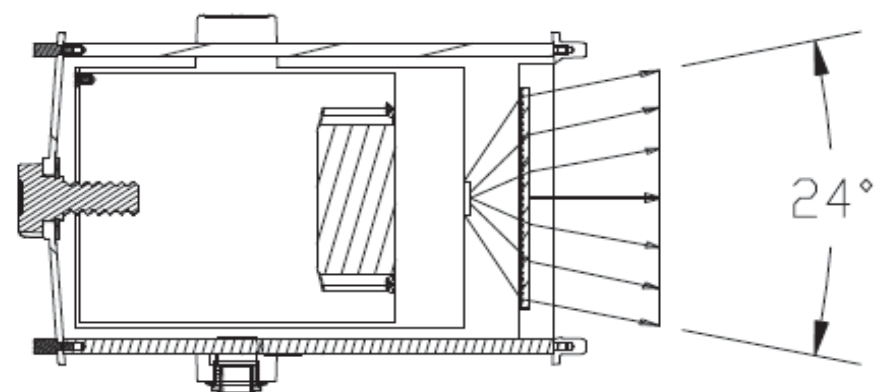
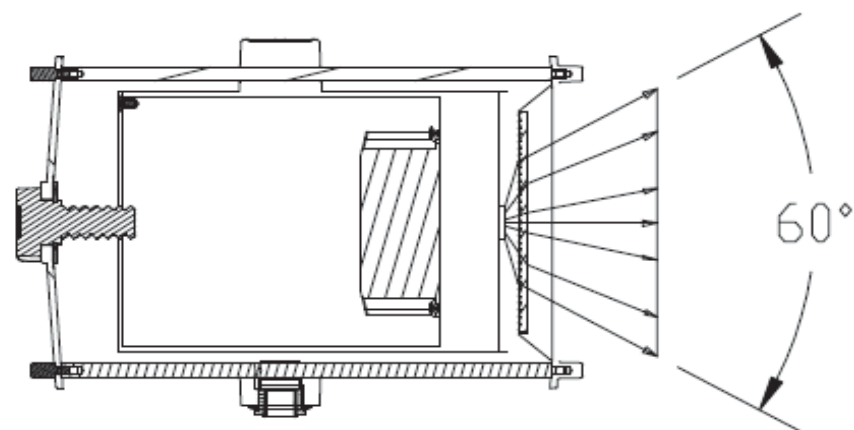

Best heat conduct & air circulation

- ❑ Material: Aluminum Alloy
- ❑ Structure: Turbo Fan Design
- ❑ Surface craft: Nano coating / painted tech for heat 10-15% better

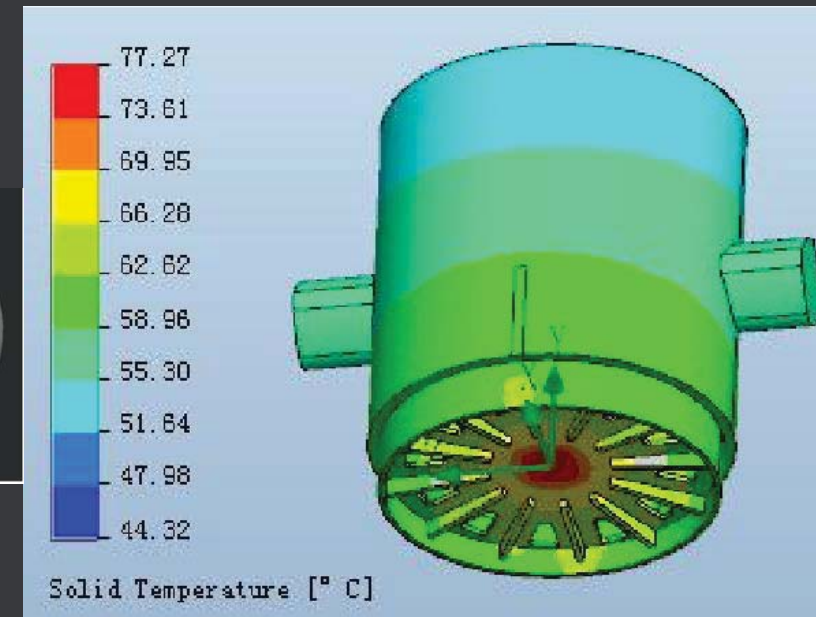

Driver

Unique Matching

- ❑ UL, RoHS, CE certification
- ❑ 5 years warranty



More options for external driver



TRIDONIC

- UL, RoHS, CE certification
- 5 years warranty

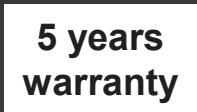

INSTALLATION

Simple Operation, Easy Installation

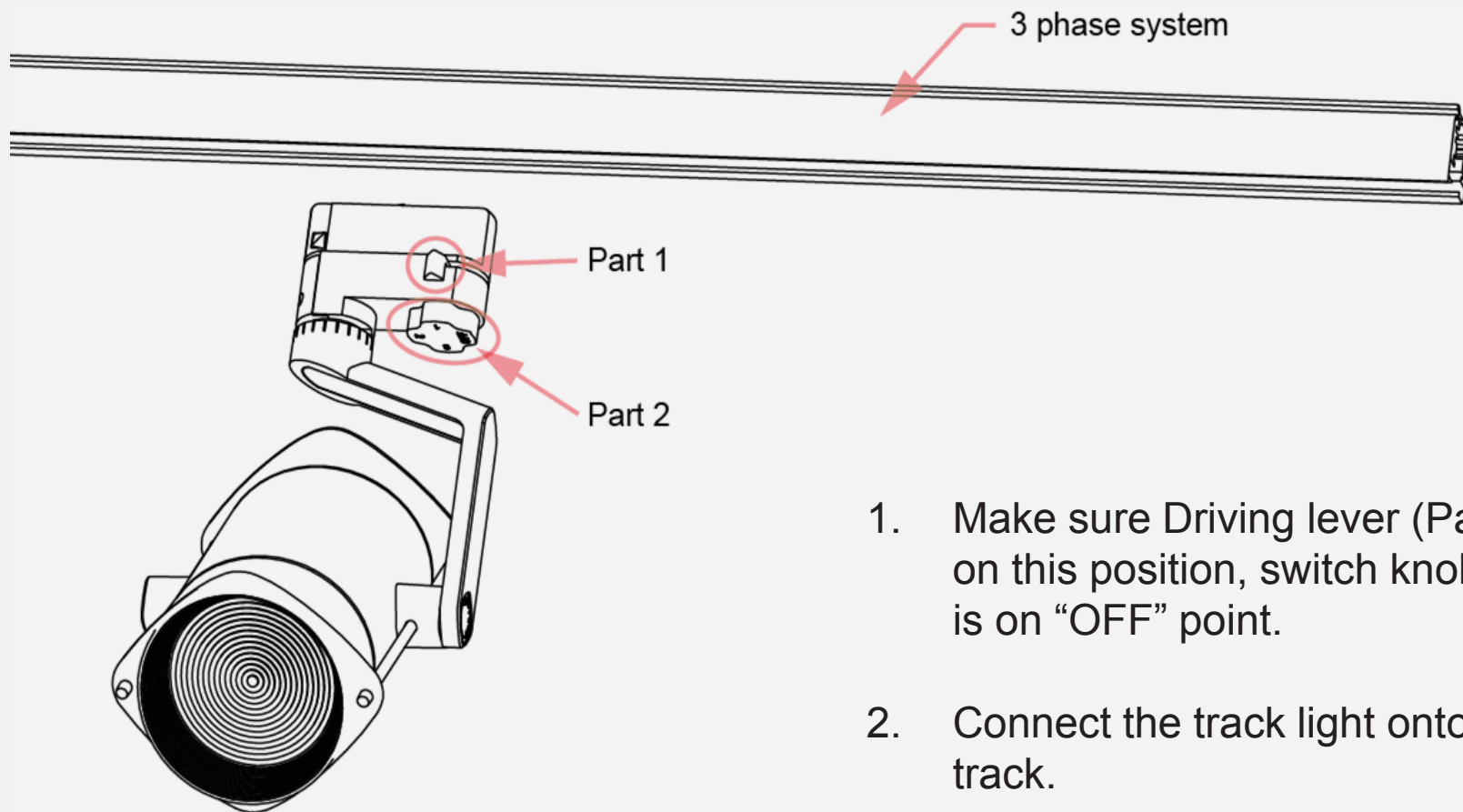

1. Make sure Driving lever (Part 1) is on this position, switch knob(Part 2) is on "OFF" point.
2. Connect the track light onto the track.

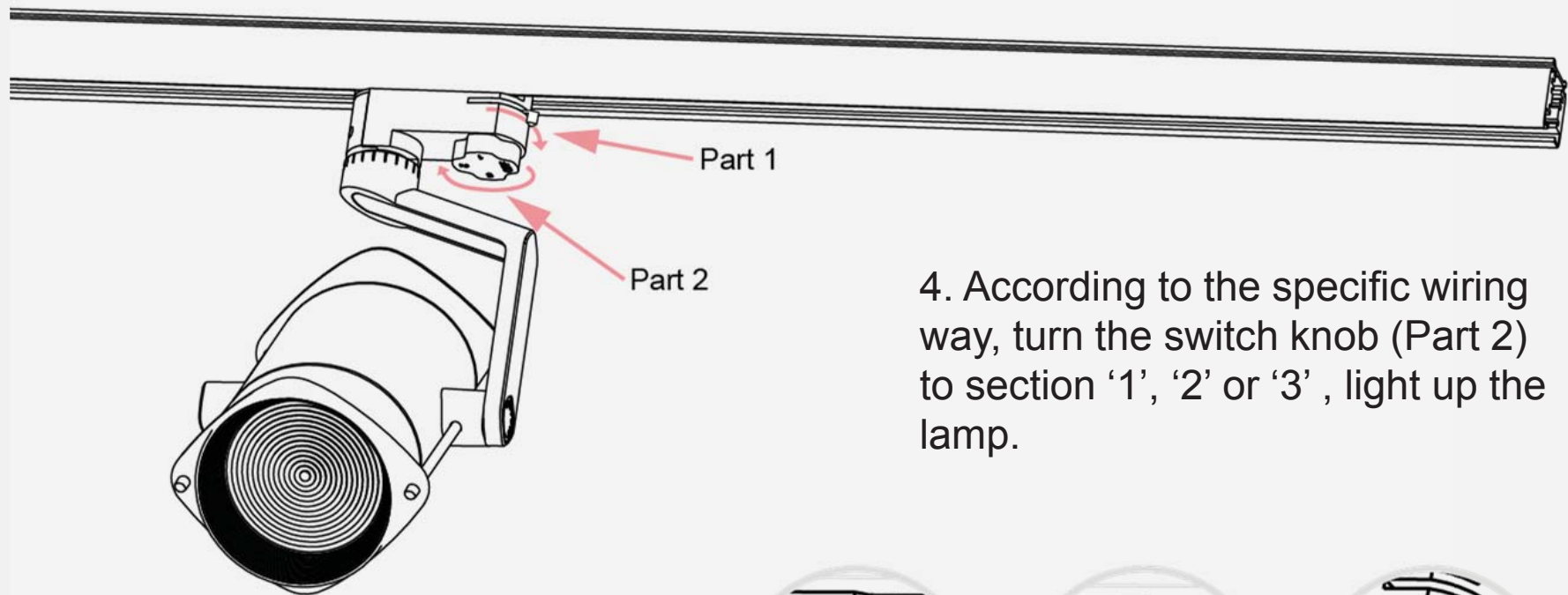

3. Turn Driving lever (Part 1) to the position which parallel with the track.

4. According to the specific wiring way, turn the switch knob (Part 2) to section '1', '2' or '3', light up the lamp.



position on 1



position on 2



position on 3

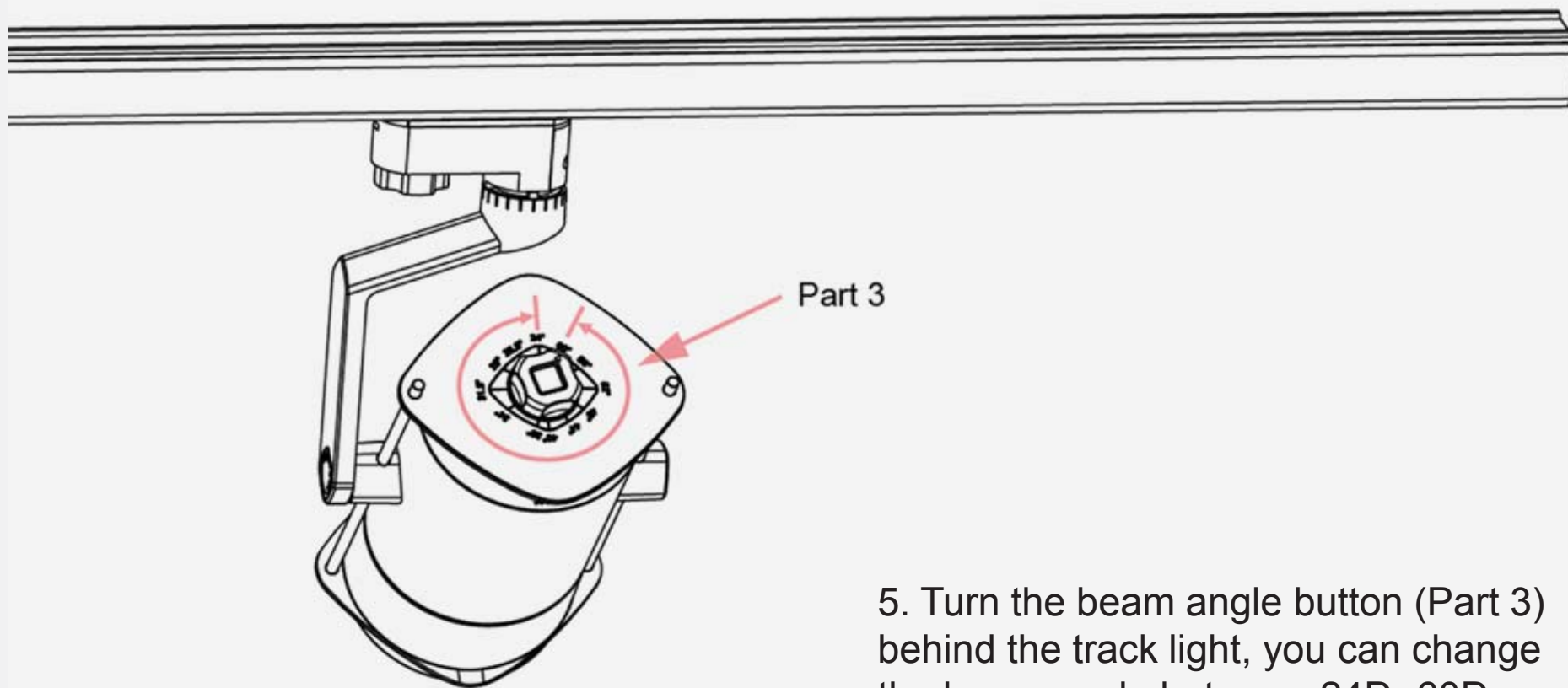

5. Turn the beam angle button (Part 3) behind the track light, you can change the beam angle between 24D- 60D.

6. Adjust the luminous direction by turning the part 4 and part 5.

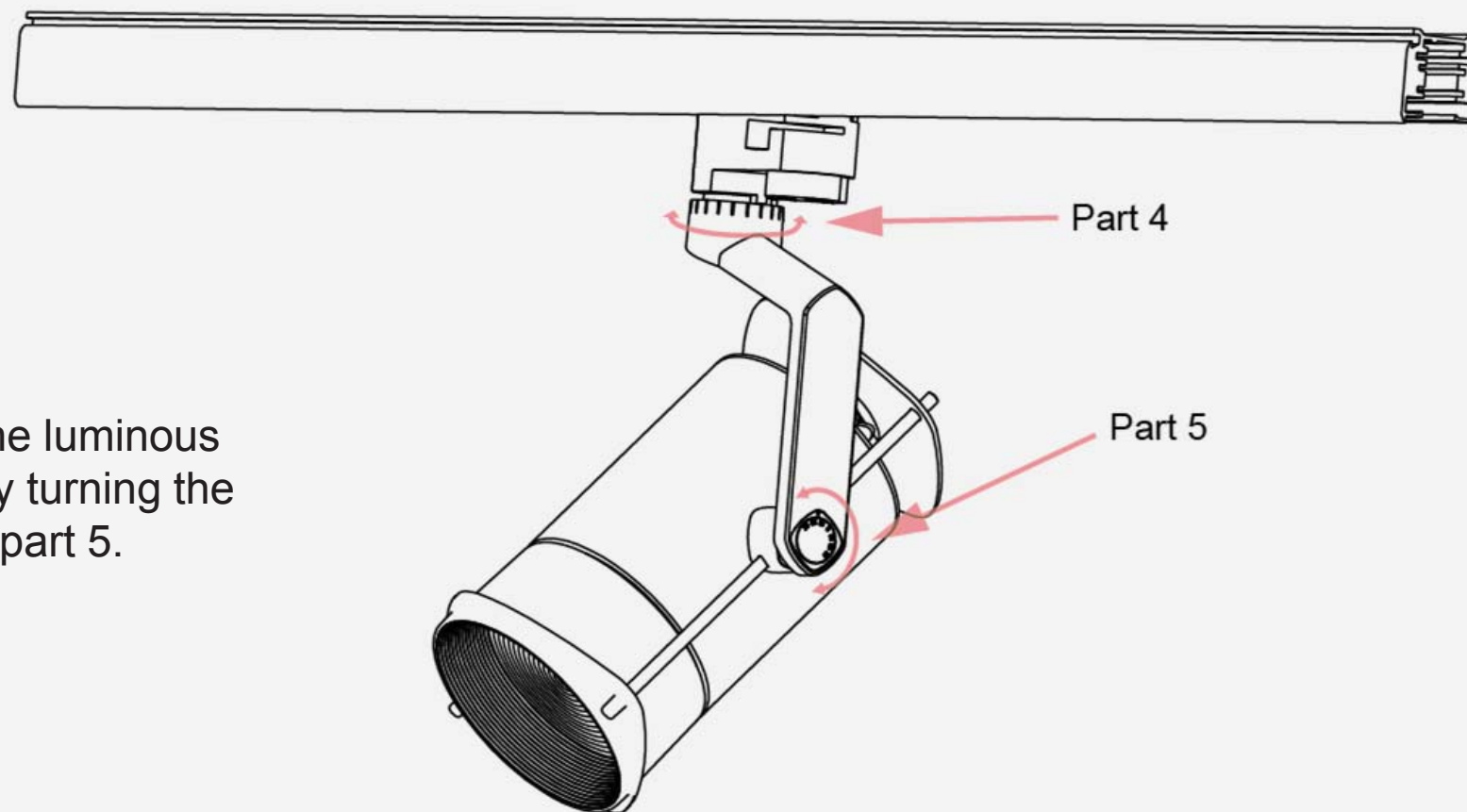

APPLICATION

Commercial & Home Lighting

Fashion Store

Make your store different

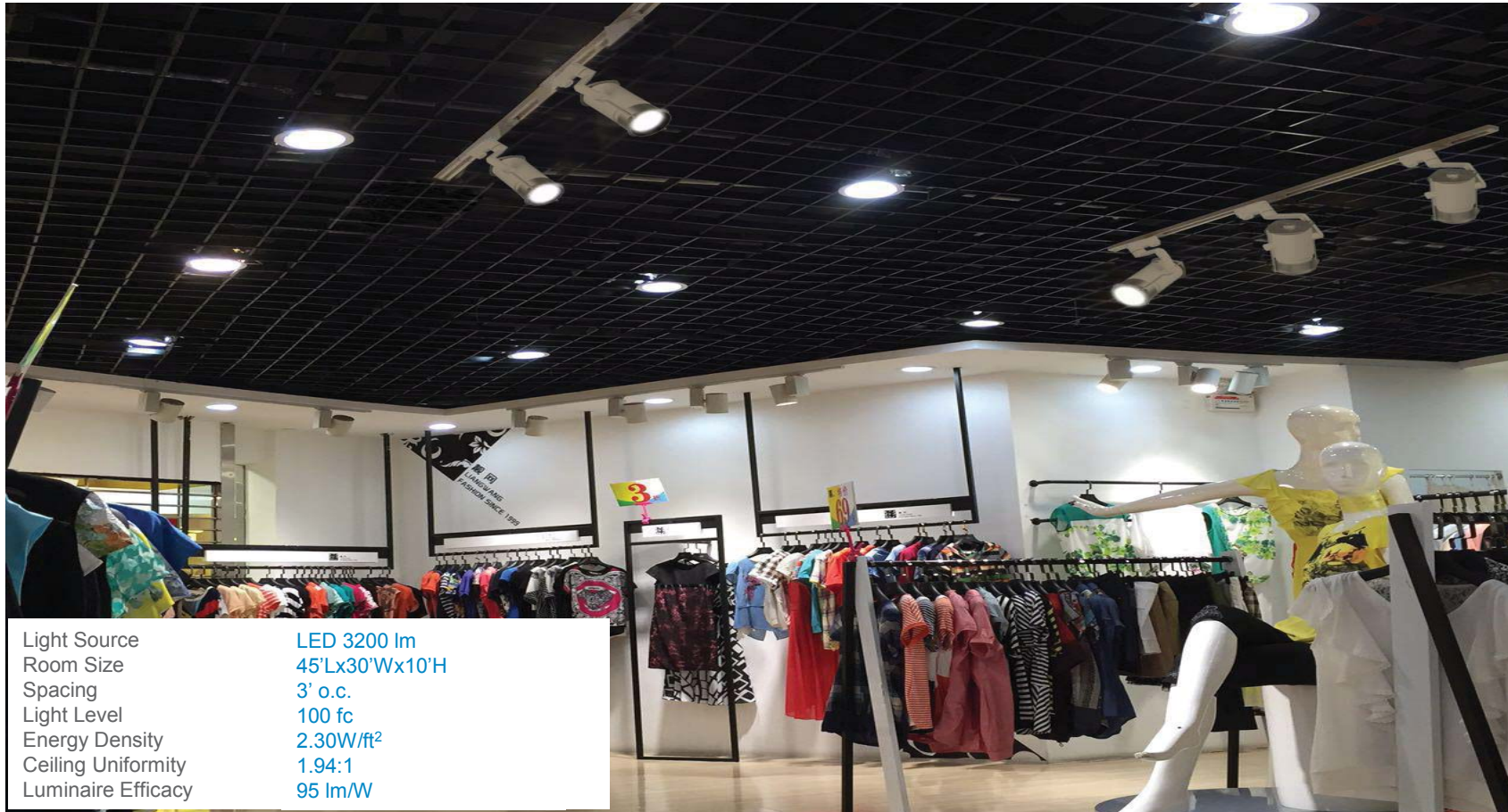

Light Source	LED 3200 lm
Room Size	45'Lx30'Wx10'H
Spacing	3' o.c.
Light Level	100 fc
Energy Density	2.30W/ft ²
Ceiling Uniformity	1.94:1
Luminaire Efficacy	95 lm/W



Museum

Light Source
Room Size
Spacing
Light Level
Energy Density
Ceiling Uniformity
Luminaire Efficacy

LED 3200 lm
7'Lx4"Wx9'H
12' o.c.
50 fc
3.60W/ft²
1.94:1
95 lm/W



Exhibition

Light Source	LED 3200 lm
Room Size	45'Lx30'Wx10'H
Spacing	3' o.c.
Light Level	39 fc
Energy Density	1.80W/ft ²
Ceiling Uniformity	1.94:1
Luminaire Efficacy	102 lm/W

Office

Light Source	LED 3200 lm
Room Size	4'Lx3'Wx9'H
Spacing	0' o.c.
Light Level	39 fc
Energy Density	2.60W/ft ²
Ceiling Uniformity	1.94:1
Luminaire Efficacy	95 lm/W



THE BEST track light, not ONE of the best !

Thank You!